

corso

pincès d'accrochage
beam clamps
balkklemmen
trägerklemmen

**Pincès / beam clamps /
balkklemmen / trägerklemmen: 1 t / 2 t / 3 t / 5 t / 10 t**

Français

English

Nederlands

Deutsch

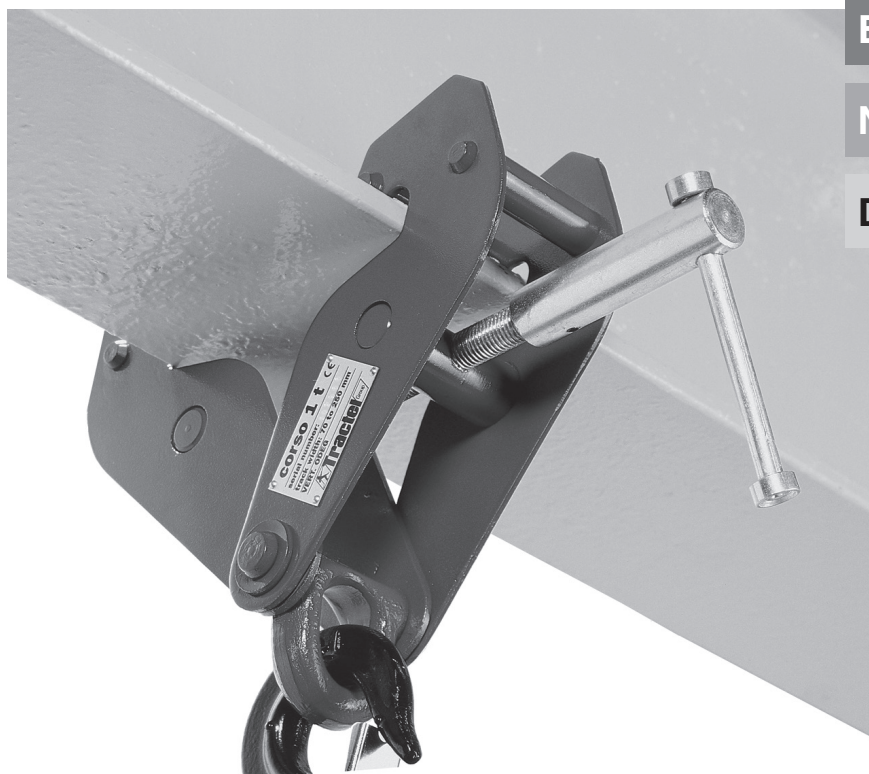

FR

Instructions d'emploi et d'entretien
Traduction de notice originale

NL

Handleiding voor gebruik en onderhoud
Vertaling van de oorspronkelijke handleiding

GB

Operation and maintenance manual
Original manual

DE

Gebrauchs- und Wartungsanleitung
Übersetzung der Originalanleitung

CONTENTS

- General warning
- 1. Description of equipment
- 2. Rigging arrangements
- 3. Installation
- 4. Anchoring
- 5. Operation
- 6. Taking out of service and storage
- 7. Maintenance
- 8. Warnings against hazardous operations
- 9. Troubleshooting
- 10. Health and safety at work
- 11. Markings

Always concerned to improve the quality of its products, the TRACTEL® reserves the right to modify the specifications of the equipment described in this manual.

The companies of the TRACTEL® and their agents or distributors will supply on request descriptive documentation on the full range of TRACTEL® products : lifting and pulling machines, permanent and temporary access equipment, safety devices, electronic load indicators, accessories such as pulley blocks, hooks, slings, ground anchors, etc

The TRACTEL® network is able to supply an after-sales and regular maintenance service.



- 1- Before using the clamp**, it is essential for the safe and correct operation of the equipment **that this manual be read** and fully understood and that all the instructions be followed. **This manual should be made** available to every operator. Extra copies of this manual will be supplied on request.
- 2-** The corso clamp allows the operator to carry out work with complete safety. Ensure that this clamp is only handed over for use or rigging to an operator who is trained to operate it in a responsible manner.
- 3-** Never use a clamp which is not in good working condition. Continuous monitoring of the condition of the machine is an important safety consideration.
- 4-** The manufacturer declines any responsibility for the consequences of dismantling or altering the machine by any unauthorized person. Specifically excluded is the replacement of original parts by parts of another manufacturer.
- 5-** The clamps described in this manual **must not be used for lifting people**.
- 6-** Moreover, these clamps are designed for manual operation and **must not be motorized**.
- 7-** Never apply or attempt to apply to the machine a load or effort greater than the working load limit.
- 8-** Corso clamps must not be used in explosive atmospheres.
- 9-** The installation of a corso clamp on an overhead metal beam requires a strength calculation to be carried out by a qualified person.

1. DESCRIPTION OF EQUIPMENT

Fig. 1 : **1.** Side plates, **2.** Adjustable screw, **3.** Anchor point.

The corso beam clamp is a lifting accessory. It has been designed for anchoring a hoist or winch to a fixed point on an overhead "I" beam (Fig. 2). The corso beam clamp is of simple design and easy to install. Once fitted correctly, it may be used with complete safety.

2. RIGGING ARRANGEMENTS

The beam clamp is anchored to a fixed point on the beam (fig.2).

NB : The beam clamp must be appropriate for the load to be lifted and consequently the capacity of the beam should be calculated by a qualified person.

3. INSTALLATION

1. Unscrew the adjustable screw to open the clamp wider than the beam.
2. Fit the clamp onto the beam. The clamp should be held in place without jamming on the beam.
3. Screw up the adjustable screw until it touches the beam. Tighten the screw manually.
4. Ensure that the clamp is in contact with the beam at points A1, A2, B1 and B2. There should be no other contact between the clamp and the beam (see Fig. 1).

4. ANCHORING

The hoist or winch should be anchored to the beam clamp by the anchor point provided.

WARNING : a load, hoist or any other object should not be anchored to any component of the clamp, other than the anchor point.

5. OPERATION

Corso beam clamps are designed for static use. Never attempt to move a beam clamp under load. Moving the position of the beam clamps should only be carried out by a qualified person.

6. TAKING OUT OF SERVICE AND STORAGE

Before taking a corso out of service, that is removing it from the beam to which it is attached, ensure that there is no load on the beam clamp or the trolley, by removing the sling, hoist or winch.

Unscrew the adjustable screw until the beam clamp is opened sufficiently to be removed from the beam.

7. MAINTENANCE

Corso beam clamps should be regularly cleaned and oiled.

8. WARNINGS AGAINST HAZARDOUS OPERATION

The use of corso beam clamps, in accordance with the instructions in this manual, is a guarantee of safety. Nevertheless, it is useful to draw the attention of users to the following warnings :

- Never use corso beam clamps or trolleys for lifting people under any circumstances.
- Never use corso units beyond their working load limit.
- Never use corso units for applications other than those for which they are intended.
- Never fit a corso unit to a beam by any means other than those described in this manual.
- Never attach loads to parts of corso units other than the anchor point provided.
- Never lift a load which is not aligned with the clamp as described in this manual.
- Never allow a load attached to corso to swing or spin.
- Never walk or stand under the suspended load.

9. TROUBLESHOOTING

If the adjustable screw is difficult to turn or is blocked, it indicates that the thread has been damaged. In this case, return the beam clamp to an approved TRACTEL® repairer.

10. HEALTH AND SAFETY AT WORK

It is the responsibility of every company to ensure that its employees have been fully and properly trained in the safe operation of the equipment.

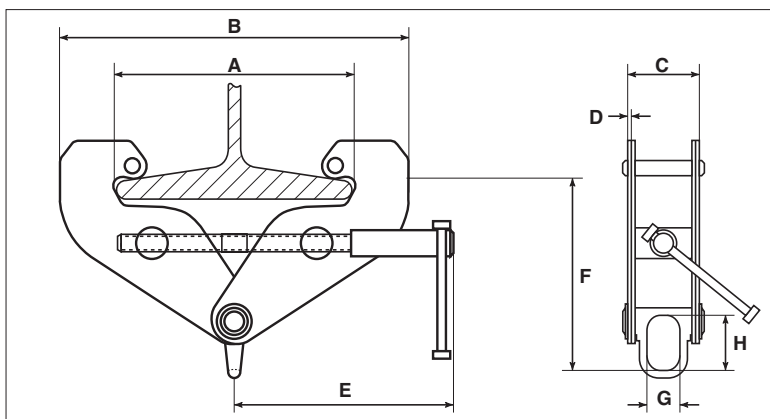

Modèles / Models / Modellen / Typ	C.M.U. / W.L.L. / Traagvermogen / Tragfähigkeit	Dimensions / Dimensions / Afmetingen / Abmessungen										 I < > I	Poids / Weight / Gewicht / Gewicht
	t	mm										mm	Kg
		A maxi	B mini	B maxi	C	D	E	F mini	F maxi	G	H		
LT - 1B	1	270	180	380	76	4	210	120	175	30	45	75 - 230	4,8
LT - 2B	2	270	182	380	84	6	210	130	180	30	40	75 - 230	5,6
LT - 3B	3	360	235	490	115	8	275	175	250	45	60	80 - 330	11
LT - 5B	5	354	253	490	138	10	245	140	220	45	60	80 - 330	12,3
LT - 10B	10	320	255	480	160	12	275	250	300	60	90	80 - 320	21

