

Section 2 Set-up and Operation

Preparation and Setup

If runway track is used . . .

1. Set the track on a support surface. Bolt it together. Runway tracks should be shimmed carefully to insure that the system remains level and plumb while it is traveling. (Consult the factory for track specifications). Make certain that the supporting foundation is adequate to support the total load. If in doubt, the supporting foundation should be verified by a qualified professional engineer.
2. Roll units in position. Lifting units must be level and plumb always. Check the lifting units and correct as needed.
3. The lifting units must be kept as close to the load as possible to minimize deflection in the lifting beams.

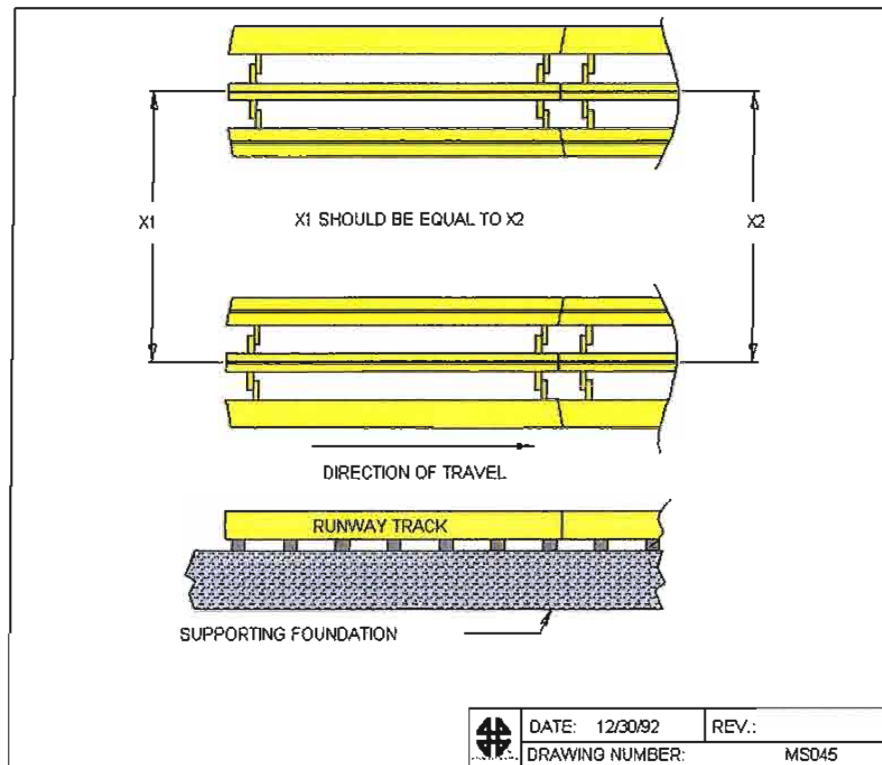

Section 2 Set-up and Operation

Warning!

Make absolutely sure the track sections are bolted to each other end to end and never use the track without the cross members. Failure to do so could cause the track to slip out from under the lifting units causing serious damage to the load or equipment and, injury or death to personnel.

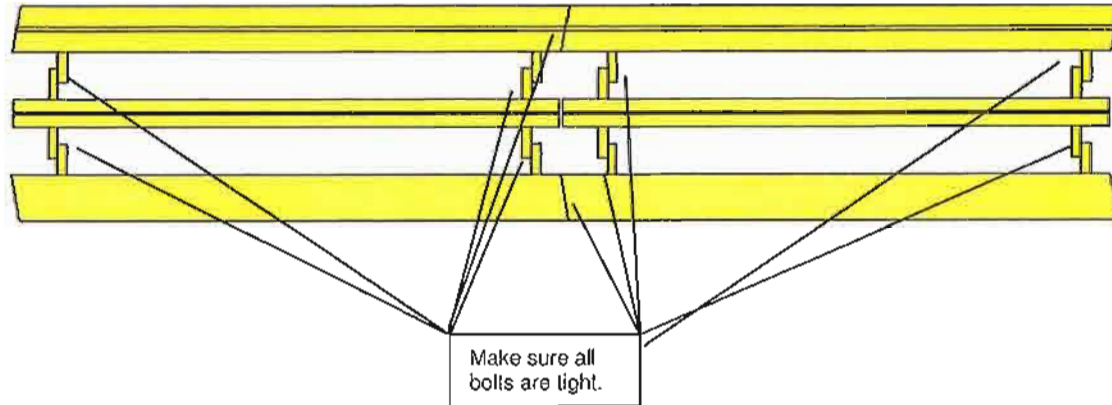

Warning!

Track must be kept level; otherwise, the system will become side-loaded and unstable.

